

Technical Specifications

General

ID	: 5150
System Wattage	: 30W LED
Driver Integral	: Constant Current
Input Voltage	: 230-240Vac
Frequency	: 50-60 Hz
Operating Voltage	: 100-277Vac
Operating Temperature	: 0°C~+50°C

Light Source

Light Source	: NICHIA
LED Lumens	: 4500 lm
CRI (Ra)	: >80
LED Colour Temperature	: 3000K / 4000K / 5700K

Driver

Power Supply	: Integral
Power Factor	: >0.95
THD	: <10%
Surge Protection	: 4KV
Efficiency	: >85%

Physical

Body	: Die-cast aluminium
Diffuser	: Polycarbonate optical lens

Mounting	: Suitable for Mounting on 50mm OD pipe
----------	---

Finish	: Powder coated Traffic Grey / Black.
--------	---------------------------------------

Optical Performance

Colour Temperature	: 3000K / 4000K / 5700K
Luminaire Luminous flux	: 2976 / 3389 / 3245 lm
Light Distribution	: Type II

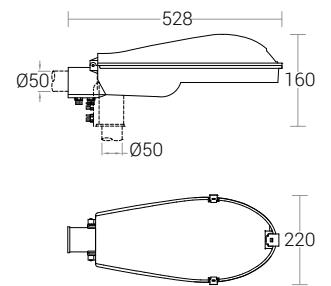

Photometric Data

