

**Technical Specifications**

**General**

ID : 4371  
 System Wattage : 50W LED  
 Driver Integral : Constant Current  
 Input Voltage : 230-240Vac  
 Frequency : 50-60Hz  
 Operating Voltage : 100-277Vac  
 Operating Temperature : -15°C~+50°C

**Light Source**

Light Source : LUMILEDS / OSRAM  
 CRI (Ra) : >70  
 LED Colour Temperature : 2700K, 3000K / 4000K  
 5700K

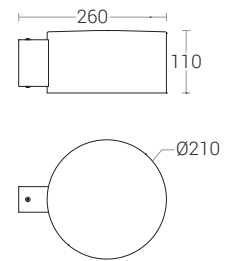

**Physical**

Body : Die-Cast Aluminium  
 Diffuser : Clear Toughened Glass  
 Mounting : Wall - Surface  
 Finish : Powder Coated  
 Graphite Grey / Jet Black  
 Anthracite Grey

**Driver**

Power Supply : Integral  
 Power Factor : >0.95  
 THD : <10%  
 Surge Protection : 6KV  
 Efficiency : >88%

**Optical Performance**

Optical Distribution : Type IV

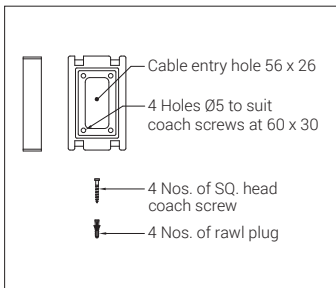

**Note :** It is our constant endeavor to upgrade the performance of our products. For the latest technical information, IES files and product updates please refer to the website at [www.klite.in](http://www.klite.in)