

Technical Specifications

General

ID	: 4370
System Wattage	: 30W LED
Driver Integral	: Constant Current
Input Voltage	: 230-240Vac
Frequency	: 50-60Hz
Operating Voltage	: 100-265Vac
Operating Temperature	: -15°C~+50°C

Physical

Body	: Extruded Aluminium
Diffuser	: Polycarbonate Optical Lens
Mounting	: Wall - Surface
Finish	: Powder Coated Graphite Grey / Jet Black Anthracite Grey

Light Source

Light Source	: LUMILEDS / OSRAM
CRI (Ra)	: >70
LED Colour Temperature	: 2700K / 3000K / 4000K 5700K

Driver

Power Supply	: Integral
Power Factor	: >0.95
THD	: <10%
Surge Protection	: 4KV
Efficiency	: >85%

Optical Performance

Light Distribution	: Type IV
--------------------	-----------

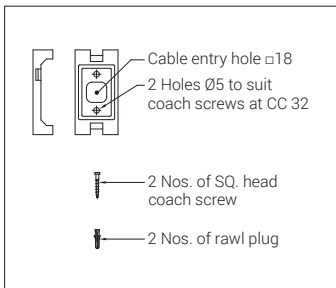
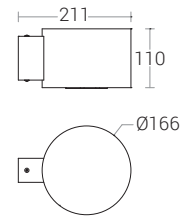

Note : It is our constant endeavor to upgrade the performance of our products. For the latest technical information, IES files and product updates please refer to the website at www.klite.in